

# ERGOTIG 20

CE EN60974-7



CODE	↔		↖	⚡
SV1410-00	4 m	12.5'	sintig	TSK 50-1/4G
SV1810-00	8 m	25'	sintig	

TECHNICAL DATA	
<b>ERGOTIG 20</b>	
	0,85 kg      1.87 lb
	113
	Argon
	0,5 ÷ 3,2 mm      .020" ÷ 1/8"
	250A DC - 220A AC
	4 bar
	1.5 l/min

CODE			
4	TQ0001		insulator 10
5	TG0020		tig 20 torch head 1
6	TG0220		tig 20 flex torch head 1
6	TG0223		tig 20 flex torch head - 125 mm 1
7	BW0063		back cap 147,5 mm 10
7	EA0129		O-ring Ø 4,5x2 mm 10
8	TT0181		kit Ergotig single 1
9	TT0182		kit Ergotig dual 1
10	BW0304		reduction 1
10	BW0310		cable joint 1
10	EA0329		screw 50
10	TP0090		Ergotig handle 1
11	TH0147		cable assembly - 4 m / 12.5' 1
11	TH0148		cable assembly - 8 m / 25' 1
12	TH0086		power cable - 4 m / 12.5' 1
12	TH0087		power cable - 8 m / 25' 1
15	CX0080		TSK 50 - quick plug 1

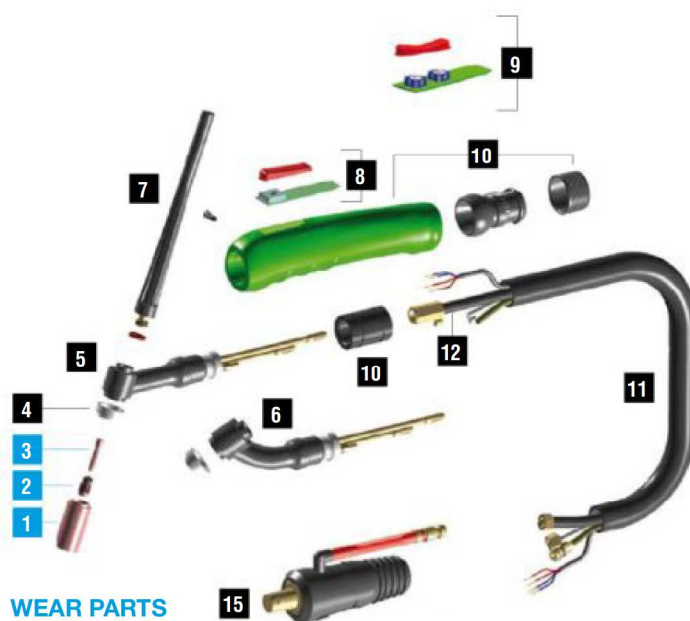

**WEAR PARTS NOT INCLUDED**

Starter kits page 360  
Wear parts page 361

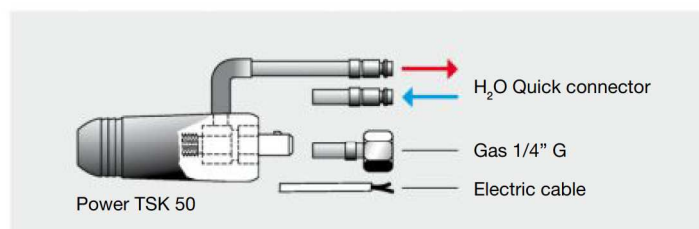

# TIG TORCH HEADS



## MANUAL

CODE			
TF0009		TIG 9	1
TF0010		TIG 9 FLEX	1
TF0222		TIG 9 FLEX 100 mm	1
TF0017		TIG 17	1
TF0022		TIG 17 FLEX	1
TF0024		TIG 24	1
TF0224		TIG 24 FLEX	1
TF0026		TIG 26	1
TF0027		TIG 26 FLEX	1

## VALVE

CODE			
TF0109		TIG 9 V	1
TF0110		TIG 9 V FLEX	1
TF0117		TIG 17 V	1
TF0118		TIG 17 V FLEX	1
TF0126		TIG 26 V	1
TF0127		TIG 26 V FLEX	1

## AUTOMATIC

CODE			
TF1000		AUTOTIG 9	1
TF1001		AUTOTIG 26	1



## FLEXLOCK

CODE			
TF0072		FLEXLOCK 17 - 18	1
TF0071		FLEXLOCK 9 - 20	1
TF0070		FLEXLOCK 9 - 17	1
BW0535		fixing screw FLEXLOCK 9 - 17 - 18 - 20	1

## MANUAL

CODE			
TG0018		TIG 18	1
TG0118		TIG 18 FLEX	1
TG0913		TIG 18 HC	1
TG0914		TIG 18 HC FLEX	1
TG0020		TIG 20	1
TG0220		TIG 20 FLEX	1
TG0223		TIG 20 FLEX 125 mm	1
TG0912		TIG 20 HC	1
TG0911		TIG 20 HC FLEX	1
TG0024		TIG 24W	1
TG0224		TIG 24W FLEX	1
TG0025		TIG 25	1
TG0917		SUPER 50	1

## AUTOMATIC

CODE			
TG1001		AUTOTIG 18	1
TG1000		AUTOTIG 20	1



## FLEXLOCK

CODE			
TF0072		FLEXLOCK 17 - 18	1
TF0071		FLEXLOCK 9 - 20	1
TG0070		FLEXLOCK 18 - 20	1
BW0535		fixing screw FLEXLOCK 9 - 17 - 18 - 20	1

# TUNGSTEN ELECTRODES

UNI EN ISO 6848-2004



CODE		$\varnothing$	$\longleftrightarrow$	
TR0001-10	<b>WP</b>	1 mm	150 mm	1
TR0001-16		1,6 mm	150 mm	1
TR0001-20		2 mm	150 mm	1
TR0001-24		2,4 mm	150 mm	1
TR0001-32		3,2 mm	150 mm	1
TR0001-40		4 mm	150 mm	1
TR0001-48		4,8 mm	150 mm	1
TR0002-10		<b>WP</b>	1 mm	175 mm
TR0002-16	1,6 mm		175 mm	1
TR0002-20	2 mm		175 mm	1
TR0002-24	2,4 mm		175 mm	1
TR0002-32	3,2 mm		175 mm	1
TR0002-40	4 mm		175 mm	1
TR0002-48	4,8 mm		175 mm	1
TR0002-64	6,4 mm		175 mm	1
TR0007-10	<b>WC20</b>	1 mm	150 mm	1
TR0007-16		1,6 mm	150 mm	1
TR0007-20		2 mm	150 mm	1
TR0007-24		2,4 mm	150 mm	1
TR0007-32		3,2 mm	150 mm	1
TR0007-40		4 mm	150 mm	1
TR0007-48		4,8 mm	150 mm	1
TR0008-10		<b>WC20</b>	1 mm	175 mm
TR0008-16	1,6 mm		175 mm	1
TR0008-20	2 mm		175 mm	1
TR0008-24	2,4 mm		175 mm	1
TR0008-32	3,2 mm		175 mm	1
TR0008-40	4 mm		175 mm	1
TR0008-48	4,8 mm		175 mm	1
TR0011-10	<b>WL10</b>		1 mm	150 mm
TR0011-16		1,6 mm	150 mm	1
TR0011-20		2 mm	150 mm	1
TR0011-24		2,4 mm	150 mm	1
TR0011-32		3,2 mm	150 mm	1
TR0011-40		4 mm	150 mm	1
TR0011-48		4,8 mm	150 mm	1
TR0012-16		<b>WL10</b>	1,6 mm	175 mm
TR0012-24	2,4 mm		175 mm	1
TR0012-32		3,2 mm	175 mm	1

CODE		$\varnothing$	$\longleftrightarrow$		
TR0013-10	<b>WL15</b>	1 mm	150 mm	1	
TR0013-16		1,6 mm	150 mm	1	
TR0013-20		2 mm	150 mm	1	
TR0013-24		2,4 mm	150 mm	1	
TR0013-32		3,2 mm	150 mm	1	
TR0013-40		4 mm	150 mm	1	
TR0013-48		4,8 mm	150 mm	1	
TR0014-10		<b>WL15</b>	1 mm	175 mm	1
TR0014-16	1,6 mm		175 mm	1	
TR0014-20	2 mm		175 mm	1	
TR0014-24	2,4 mm		175 mm	1	
TR0014-32	3,2 mm		175 mm	1	
TR0014-40	4 mm		175 mm	1	
TR0014-48	4,8 mm		175 mm	1	
TR0017-10	<b>WL20</b>		1 mm	150 mm	1
TR0017-16		1,6 mm	150 mm	1	
TR0017-20		2 mm	150 mm	1	
TR0017-24		2,4 mm	150 mm	1	
TR0017-32		3,2 mm	150 mm	1	
TR0017-40		4 mm	150 mm	1	
TR0017-48		4,8 mm	150 mm	1	
TR0018-10		<b>WL20</b>	1 mm	175 mm	1
TR0018-16	1,6 mm		175 mm	1	
TR0018-20	2 mm		175 mm	1	
TR0018-24	2,4 mm		175 mm	1	
TR0018-32	3,2 mm		175 mm	1	
TR0018-40	4 mm		175 mm	1	
TR0021-10	<b>WR2</b>		1 mm	150 mm	1
TR0021-16			1,6 mm	150 mm	1
TR0021-20		2 mm	150 mm	1	
TR0021-24		2,4 mm	150 mm	1	
TR0021-32		3,2 mm	150 mm	1	
TR0021-40		4 mm	150 mm	1	
TR0021-48		4,8 mm	150 mm	1	
TR0022-10		<b>WR2</b>	1 mm	175 mm	1
TR0022-16	1,6 mm		175 mm	1	
TR0022-20	2 mm		175 mm	1	
TR0022-24	2,4 mm		175 mm	1	
TR0022-32	3,2 mm		175 mm	1	
TR0022-40	4 mm		175 mm	1	

# WEAR PARTS KITS



## STARTER KITS



### 9 - 20 - 20 HC - 25

CODE	Ø			
TT0101	1,6 mm	1/16"	WR2	1
TT0102	2,4 mm	3/32"	WR2	1

### 17 - 18 - 18 HC - 26

CODE	Ø			
TT0103	1,6 mm	1/16"	WR2	1
TT0104	2,4 mm	3/32"	WR2	1
TT0105	3,2 mm	1/8"	WR2	1

### 24 - 24W

CODE	Ø			
TT0203	1,6 mm	1/16"	WC20	1
TT0204	2,4 mm	3/32"	WC20	1

## MASTER KITS



### 9 - 20 - 20 HC - 25

CODE	Ø			
TT0109	1,0 mm - 1,6 mm - 2,0 mm - 2,4 mm - 3,2 mm			1

### 17 - 18 - 18 HC - 26

CODE	Ø			
TT0110	1,6 mm - 2,0 mm - 2,4 mm - 3,2 mm - 4,0 mm			1

## STARTER KITS



### 9 - 20 - 20 HC - 25

CODE	Ø			
TT0221	1,6 mm	1/16"		1
TT0222	2,4 mm	3/32"		1

### 17 - 18 - 18 HC - 26

CODE	Ø			
TT0223	1,6 mm	1/16"		1
TT0224	2,4 mm	3/32"		1

### 24 - 24W

CODE	Ø			
TT0226	1,6 mm	1/16"		1

## STARTER KITS WITH BACK CAP



### 9 - 20 - 20 HC - 25

CODE	Ø			
TT0021	1,6 mm	1/16"	WC20	1
TT0022	2,4 mm	3/32"	WC20	1

### 17 - 18 - 18 HC - 26

CODE	Ø			
TT0023	1,6 mm	1/16"	WC20	1
TT0024	2,4 mm	3/32"	WC20	1
TT0025	3,2 mm	1/8"	WC20	1

# SERIES 9 - 20 - 25 - SUPER 20 WEAR PARTS



## STANDARD

	CODE		Gr	Ø	↔	REF	
1	TC0012		4	6,4 mm 1/4"	30 mm	13N08	10
1	TC0013		5	8 mm 5/16"	30 mm	13N09	10
1	TC0014		6	9,8 mm 3/8"	30 mm	13N10	10
1	TC0015		7	11,2 mm 7/16"	30 mm	13N11	10
1	TC0016		8	12,7 mm 1/2"	30 mm	13N12	10
1	TC0017		10	15,7 mm 5/8"	30 mm	13N13	10
1	TC0096		4	6,5 mm 1/4"	48 mm	796F71	10
1	TC0097		5	8 mm 5/16"	48 mm	796F72	10
1	TC0098		6	9,5 mm 3/8"	48 mm	796F73	10
1	TC0101		4	6,5 mm 1/4"	63 mm	796F75	10
1	TC0102		5	8 mm 5/16"	63 mm	796F76	10
1	TC0103		4	6,5 mm 1/4"	89 mm	796F79	10
2	TE0003-05			0,5 mm .020"	21 mm	13N25	10
2	TE0003-10			1,0 mm .040"	21 mm	13N26	10
2	TE0003-16			1,6 mm 1/16"	21 mm	13N27	10
2	TE0003-20			2,0 mm 5/64"	21 mm	-	10
2	TE0003-24			2,4 mm 3/32"	21 mm	13N28	10
2	TE0003-32			3,2 mm 1/8"	21 mm	13N29	10

	CODE		Gr	Ø	↔	REF	
3	TD0003-05			0,5 mm .020"	25 mm	13N20	10
3	TD0003-10			1,0 mm .040"	25 mm	13N21	10
3	TD0003-16			1,6 mm 1/16"	25 mm	13N22	10
3	TD0003-20			2,0 mm 5/64"	25 mm	-	10
3	TD0003-24			2,4 mm 3/32"	25 mm	13N23	10
3	TD0003-32			3,2 mm 1/8"	25 mm	13N24	10
4	TQ0001					598882	10
7	BW0063				147,5 mm	41V24	10
7	BW0064				53 mm	41V35	10
7	BW0065				17,5 mm	41V33	10
7	EA0129						10

## GAS LENS

	CODE		Gr	Ø	↔	REF	
1	TC0041		4	6,4 mm 1/4"	25,5 mm	53N58	10
1	TC0042		5	8 mm 5/16"	25,5 mm	53N59	10
1	TC0043		6	9,8 mm 3/8"	25,5 mm	53N60	10
1	TC0044		7	11,2 mm 7/16"	25,5 mm	53N61	10
1	TC0045		8	12,7 mm 1/2"	25,5 mm	53N61S	10
2	TE0005-05			0,5 mm .020"	22 mm	45V41	10
2	TE0005-10			1,0 mm .040"	22 mm	45V42	10
2	TE0005-16			1,6 mm 1/16"	22 mm	45V43	10
2	TE0005-20			2,0 mm 5/64"	22 mm	-	10
2	TE0005-24	Cu + CuZn		2,4 mm 3/32"	22 mm	45V44	10
2	TE0005-32			3,2 mm 1/8"	22 mm	45V45	10
2	TE0025-16			1,6 mm 1/16"	22 mm	-	10
2	TE0025-20			2,0 mm 5/64"	22 mm	-	10
2	TE0025-24	Cu		2,4 mm 3/32"	22 mm	-	10
2	TE0025-32			3,2 mm 1/8"	22 mm	-	10
3	TD0003-05			0,5 mm .020"	25 mm	13N20	10
3	TD0003-10			1,0 mm .040"	25 mm	13N21	10
3	TD0003-16			1,6 mm 1/16"	25 mm	13N22	10
3	TD0003-20			2,0 mm 5/64"	25 mm	-	10
3	TD0003-24			2,4 mm 3/32"	25 mm	13N23	10
3	TD0003-32			3,2 mm 1/8"	25 mm	13N24	10
4	TQ0001					598882	10
7	BW0063				147,5 mm	41V24	10
7	BW0064				53 mm	41V35	10
7	BW0065				17,5 mm	41V33	10
7	EA0129						10

## GAS LENS XL (JUMBO)

	CODE		Gr	Ø	↔	REF	
1	TC0118		8	12,7 mm 1/2"	48 mm	57N74	10
1	TC0119		10	15,7 mm 5/8"	48 mm	53N88	10
1	TC0120		12	19,5 mm 3/4"	48 mm	53N87	10
2	TE0088-16			1,6 mm 1/16"	40 mm	45V116S	2
2	TE0088-24			2,4 mm 3/32"	40 mm	45V64S	2
2	TE0088-32			3,2 mm 1/8"	40 mm	-	2
3	TD0088-16			1,6 mm 1/16"	40 mm	13N22L	10
3	TD0088-20			2,0 mm 5/64"	40 mm	-	10
3	TD0088-24			2,4 mm 3/32"	40 mm	13N23L	10
3	TD0088-32			3,2 mm 1/8"	40 mm	13N24L	10
4	TQ0026					54N6320	10
7	BW0063				147,5 mm	41V24	10
7	BW0064				53 mm	41V35	10
7	BW0065				17,5 mm	41V33	10
7	EA0129						10

Gas protection flow is usually guttered by a STANDARD ceramic nozzle (picture 1). Such flow is affected by turbulences of head torch which are caused by the inlet pressure. In order to assure an uniform gas distribution, above all in stainless steel, titanium and aluminium alloys welding, we suggest the use of GAS LENS spare parts. The electrode holder equipped with a gas lens net, uniform the flow (picture 2) and aid to save the protection gas. Where permitted by external dimensions, it is recommended the JUMBO version which increases the protected surface with advantage for welding quality (picture 3).

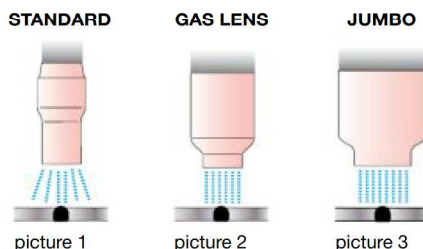

# TIG BLISTERED WEAR PARTS



CODE		DESCRIPTION	SIZE	PCS X	BOX X
BW0056P		tig cap 58 mm	17 - 18 - 26	3	10
BW0064P		back cap 53 mm	9 - 20	3	10
BW0065P		back cap 17,5 mm	9 - 20	3	10
BW0067P		back cap 22,5 mm	17 - 18 - 26	3	10
TC0003P		gr 5	17 - 18 - 26	6	10
TC0004P		gr 6	17 - 18 - 26	6	10
TC0005P		gr 7	17 - 18 - 26	6	10
TC0006P		gr 8	17 - 18 - 26	6	10
TC0007P		gr 10	17 - 18 - 26	6	10
TC0008P		gr 12	17 - 18 - 26	6	10
TC0012P		gr 4	9 - 20	6	10
TC0013P		gr 5	9 - 20	6	10
TC0014P		gr 6	9 - 20	6	10
TC0015P		gr 7	9 - 20	6	10
TC0016P		gr 8	9 - 20	6	10
TC0017P		gr 10	9 - 20	6	10
TD0001P16		Ø 1.6	17 - 18 - 26	4	10
TD0001P20		Ø 2.0	17 - 18 - 26	4	10
TD0001P24		Ø 2.4	17 - 18 - 26	4	10
TD0001P32		Ø 3.2	17 - 18 - 26	4	10
TD0001P40		Ø 4.0	17 - 18 - 26	4	10
TD0003P16		Ø 1.6	9 - 20	4	10
TD0003P20		Ø 2.0	9 - 20	4	10
TD0003P24		Ø 2.4	9 - 20	4	10
TD0003P32		Ø 3.2	9 - 20	4	10

CODE		DESCRIPTION	SIZE	PCS X	BOX X
TE0001P16		Ø 1.6	17 - 18 - 26	3	10
TE0001P20		Ø 2.0	17 - 18 - 26	3	10
TE0001P24		Ø 2.4	17 - 18 - 26	3	10
TE0001P32		Ø 3.2	17 - 18 - 26	3	10
TE0001P40		Ø 4.0	17 - 18 - 26	3	10
TE0003P16		Ø 1.6	9 - 20	3	10
TE0003P20		Ø 2.0	9 - 20	3	10
TE0003P24		Ø 2.4	9 - 20	3	10
TE0003P32		Ø 3.2	9 - 20	3	10
TQ0001P		insulator	9 - 20	3	10
TQ0002P		insulator	17 - 18 - 26	3	10

